

Class 125 (Standard) Fig. 3358 Straight Tee



For Listings / Approval Details and Limitations, visit our website at www.asc-es.com or contact an ASC Engineered Solutions™ Sales Representative.

Material Specifications

Dimensions: ASME B16.4 Class 125

Material: ASTM A126

Finish: Black or Hot Dip Galvanized per ASTM A153 Class A

Threads: NPT per ASME B1.20.1

Agency Approvals: Fig 3358 Straight Tee sizes 1/2" – 2 1/2" are UL/ULC Listed and FM Approved.

Figure 3358 Straight Tee

Nominal Size	Maximum Working Pressure ▲	Dimension A	Approx. Wt. Each
In. (mm)	psi (kPa)	In. (mm)	Lbs. (kg)
1/2	300	1.12	0.51
13	2065	28.40	0.23
3/4	300	1.31	0.81
19	2065	33.30	0.37
1	300	1.50	1.21
25	2065	38.10	0.55
1 1/4	300	1.75	1.87
32	2065	44.45	0.85
1 1/2	300	1.94	2.51
40	2065	49.27	1.14
2	300	2.25	3.96
50	2065	57.15	1.80
2 1/2	300	2.70	6.45
65	2065	68.58	2.93

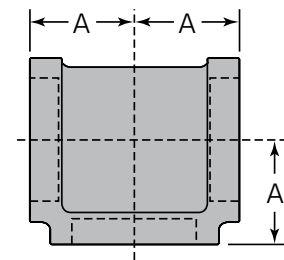

▲ – Working Pressure Ratings are for reference only and based on Sch. 40 pipe. For the latest UL/ULC, and FM pressure ratings versus pipe schedule, please visit asc-es.com or contact your local ASC Engineering Solutions™ Representative.

PROJECT INFORMATION	APPROVAL STAMP
Project:	Approved
Address:	Approved as noted
Contractor:	Not approved
Engineer:	Remarks:
Submittal Date:	
Notes 1:	
Notes 2:	